



FINSULCUT™-100

Insulation Cutting Station

User Manual

A professional Cutting Station for all types of insulation, including fiberglass, mineral wool, wood fiber, and more.

Max cutting width: 25" (635mm)

Thickness Range: 3" - 11.8" (80-300mm)

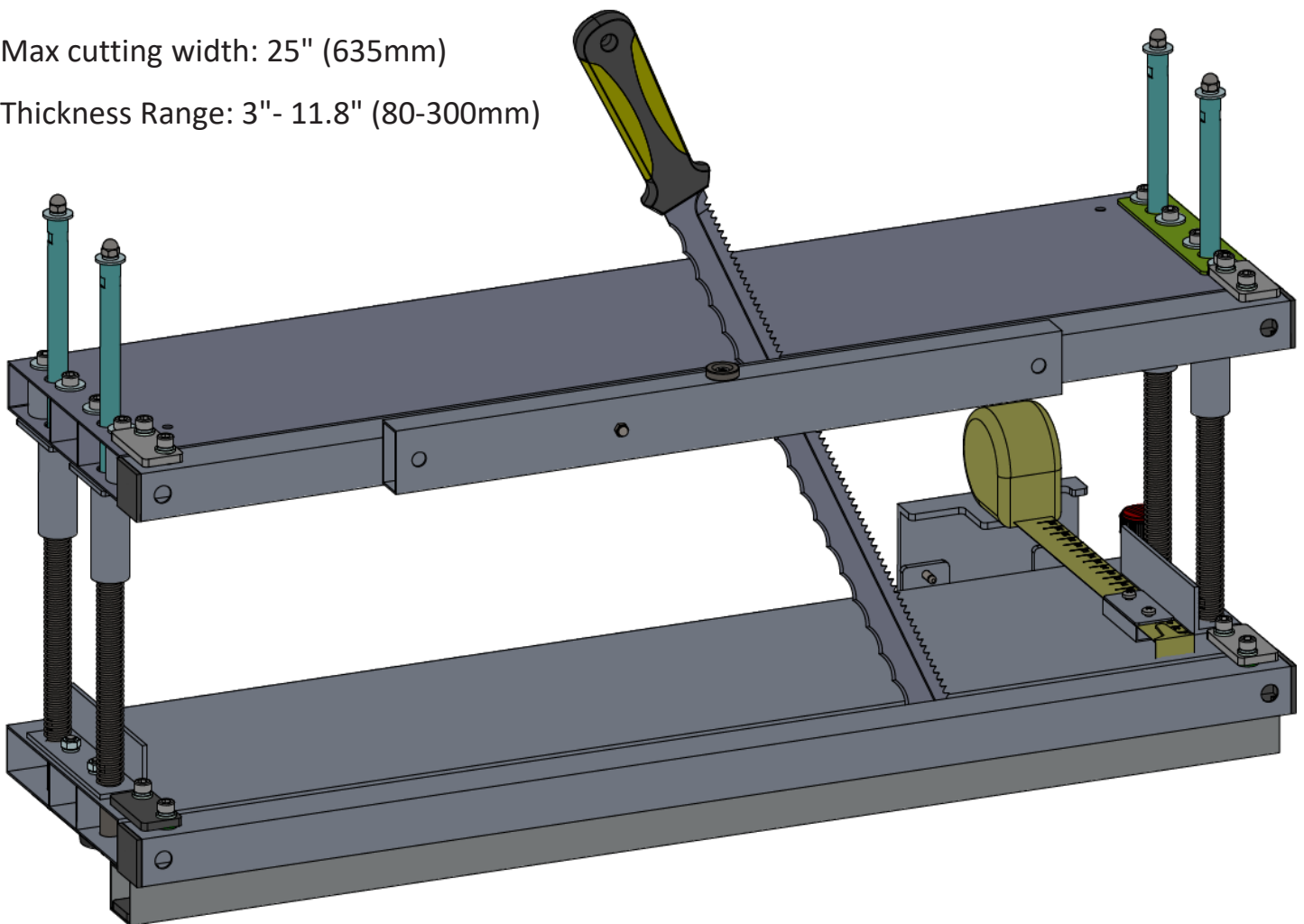

- Please read these instructions carefully before operation
- Take special note of the guidelines and safety prompts in these instructions to avoid injury to yourself, other people and objects, or damage to the tool.

Initial Setup for FINSULCUT™-100 Insulation Cutting Station

Remove all contents from the outer carton.

- FINSULCUT™-100 Insulation Cutting Station
- Permanent Posts x 4 and Installation Tools (in corrugated inner carton)
- Dual Blade Insulation Knife

The FINSULCUT™-100 Insulation Cutting Station arrives with short upper posts to minimize the overall size of the packaging. These short upper posts must be replaced prior to use to achieve the maximum cutting depth of FINSULCUT-100. Follow the steps below to replace the temporary posts with the permanent posts.

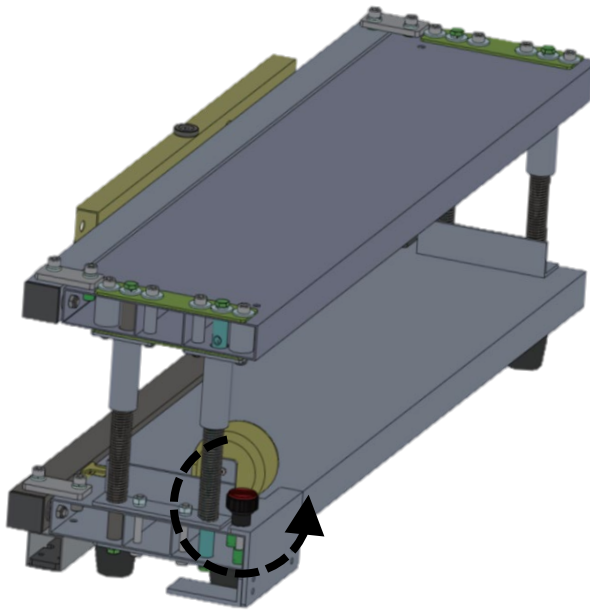

1. Loosen the knob that secures the built-in measuring tape stand.

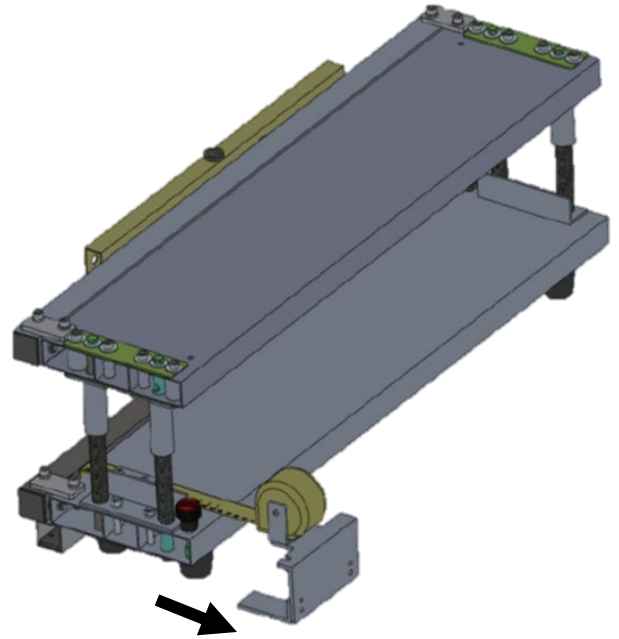

2. Slide the measuring tape stand approximately 6" away from the cutting station. The self-locking mechanism will hold the measuring tape and stand in position.

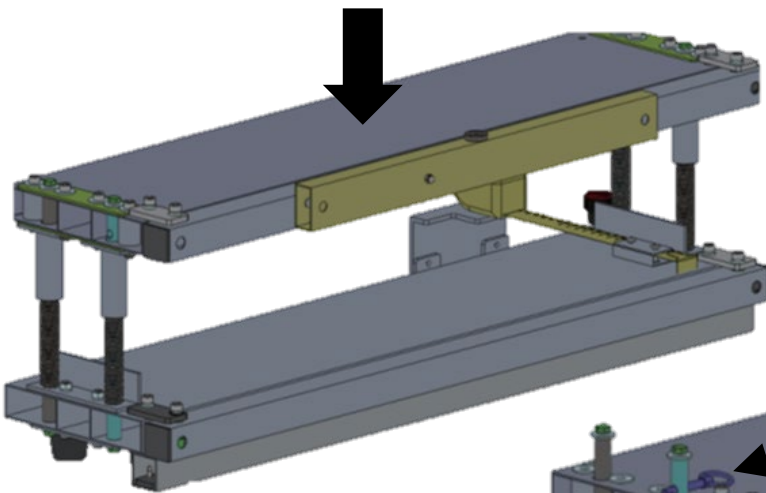

3. Step on the station to depress the top plate.

4. Insert the locking pins at each end to hold the plate in position.

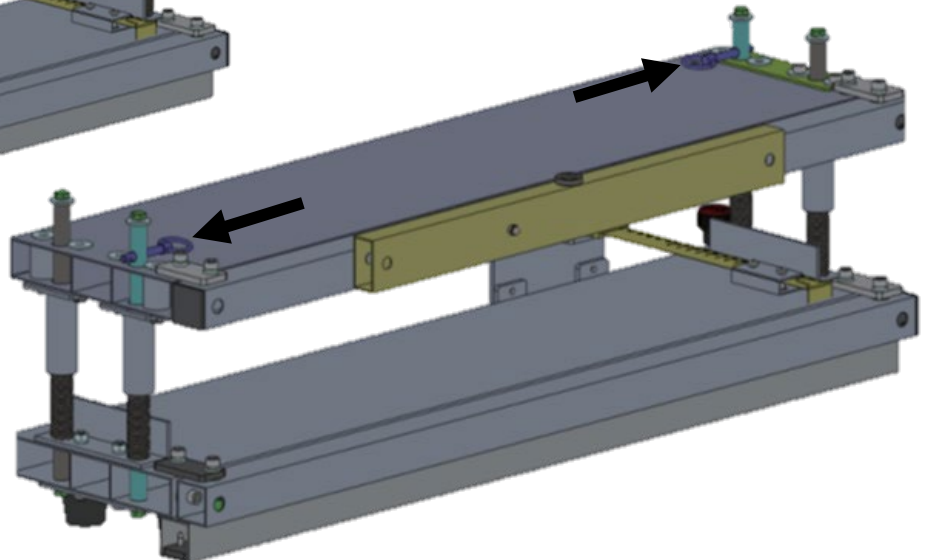

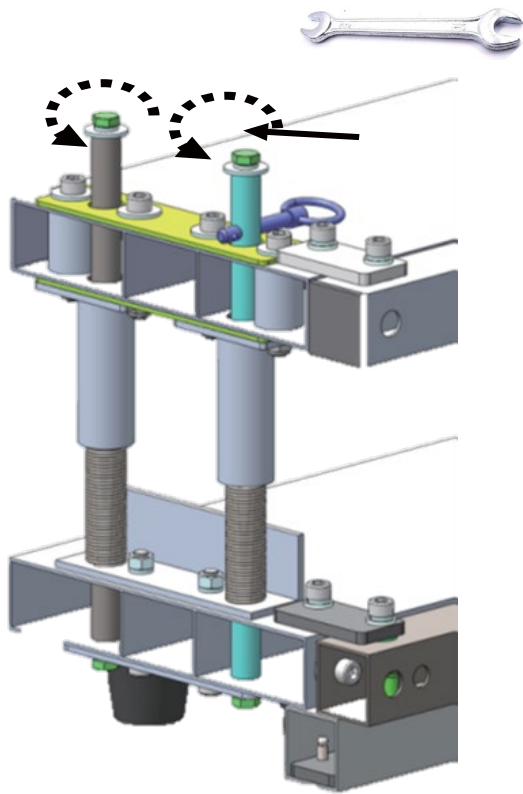

1. Using the provided wrench, remove the four short posts – two at each end of the station.

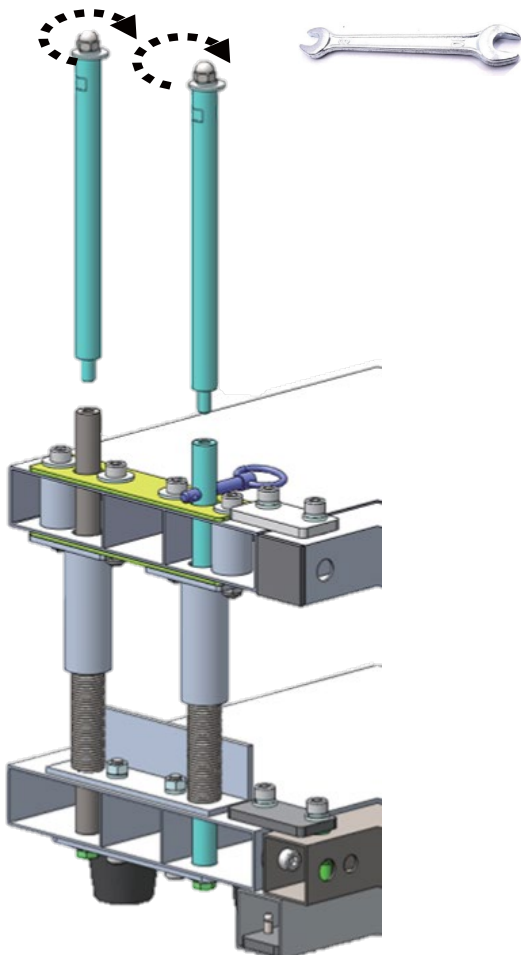
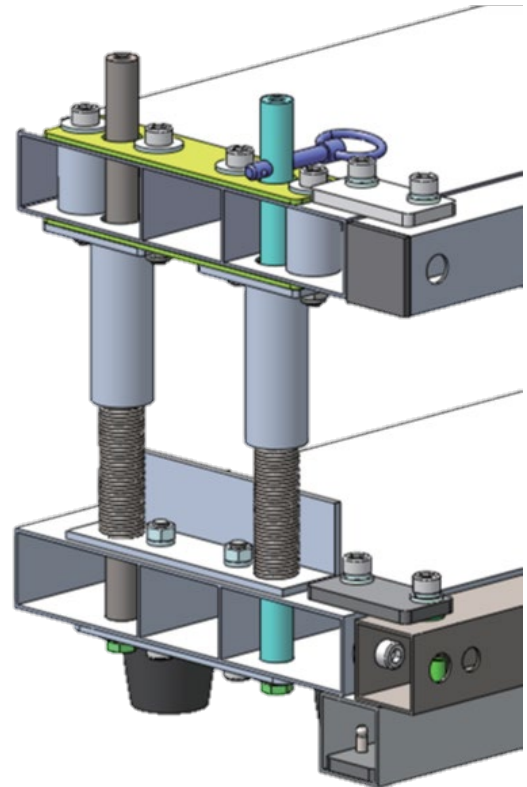

2. Insert the four long posts and then tighten the bolts using the provided wrench.

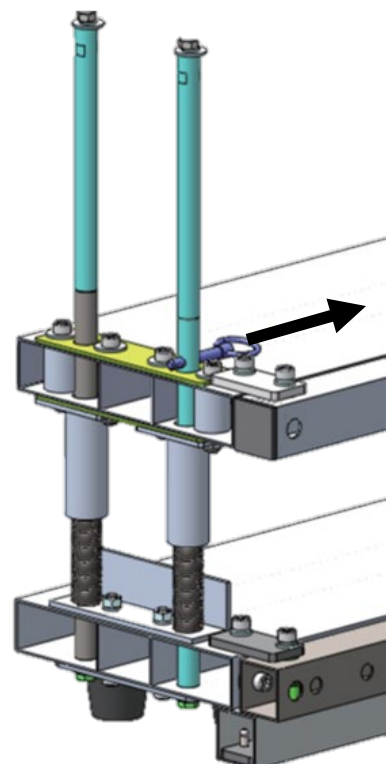

3. Remove the locking pins.

FINSULCUT™-100 Insulation Cutting Station: OPERATION



Insert the insulation material between the upper and lower plates of the FINSULCUT™-100 Insulation Cutting Station. Using the built-in measuring tape – which is calibrated to the cutting slot of the station – move the material to the required measurement.

The FINSULCUT™-100 works with all types of insulation, including fiberglass, mineral wool, wood fiber, and more.



Place your preferred foot in the center of the top plate of the FINSULCUT™-100 Insulation Cutting Station.

You can stand on either side of the station, and you can use either foot to operate the tool.

Remove the insulation knife from the knife sheath.



Step down on the top plate to compress the insulation material using the natural weight of your body.

Insert the insulation knife through the slot in the top plate, making sure the knife is aligned with the slot in the bottom plate. This guarantees a straight and square cut through the entire thickness of the insulation material.

Begin cutting the material, working your way through the full width, and being sure the knife is engaging both the upper and lower slots.

Complete the cut, remove the waste, and replace the knife back into the sheath.

FINSULCUT™-100 Insulation Cutting Station – Key Components

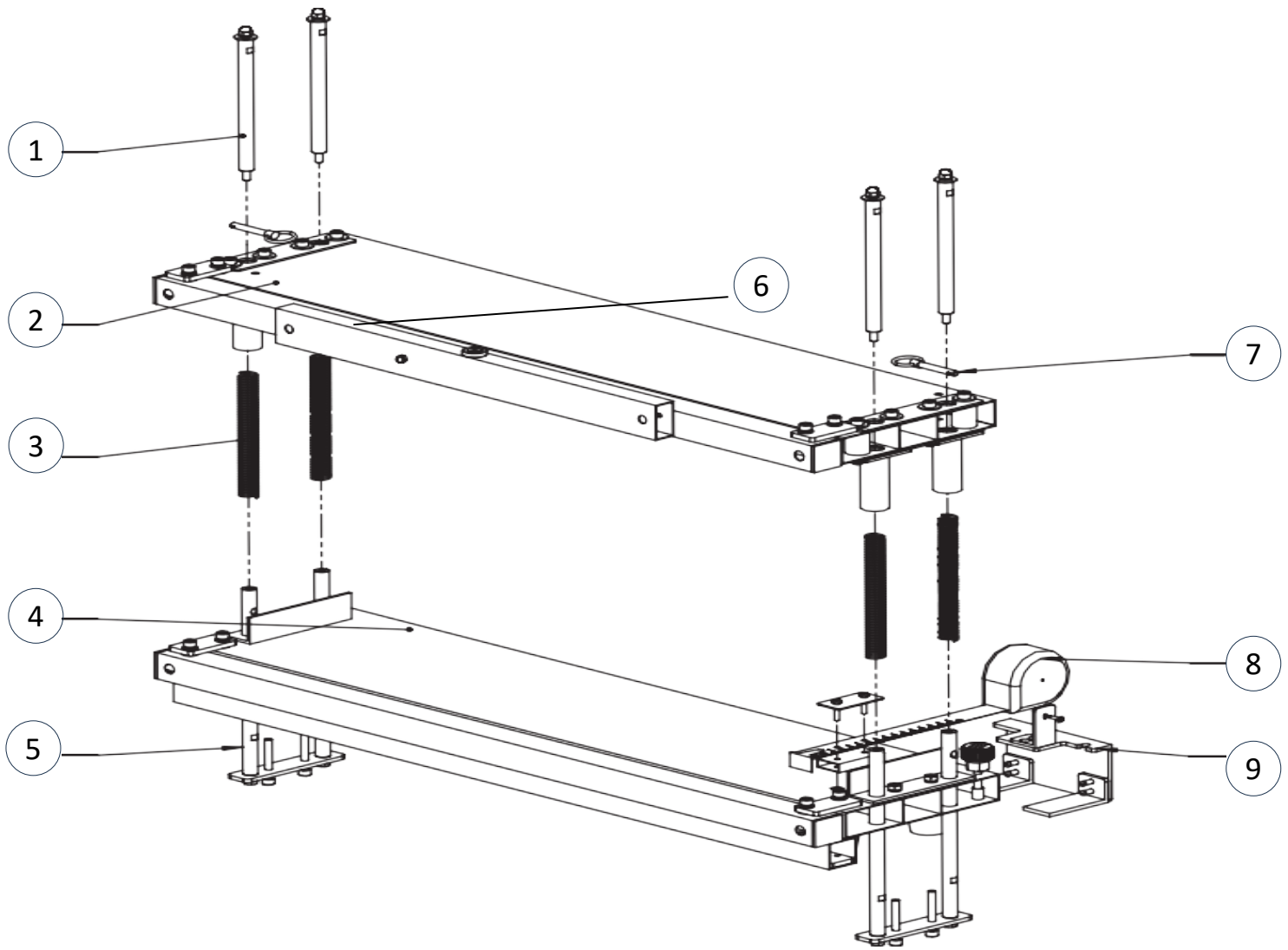

1. Upper Guide Rod Assembly
2. Upper Plate Assembly
3. Spring
4. Lower Plate Assembly
5. Lower Guide Rod Assembly

6. Insulation Knife Sheath
7. Locking Pin
8. Tape Measure
9. Tape Measure Stand

Check out the entire range of TapeTech insulation tools at

www.tapetech.com