



WOOLCUT™-300

Insulation Cutting Station

User Manual



- Please read these instructions carefully before operation
- Take special note of the guidelines and safety prompts in these instructions to avoid injury to yourself, other people and objects, or damage to the tool.

Intended Use

WOOLCUT™-300 is a professional Insulation Cutting Station that provides a strong, stable fixture to quickly and accurately cut various flexible and compressed building insulation materials, including natural fibers such as Wood or Hemp Fiber, Mineral Wools like RockWool or Glass Wool, and insulation materials made of PUR/PIR (rigid polyurethane foam), polystyrene, sponge, etc.

WOOLCUT™-300 can be used with WoolCut18 Cordless Insulation Saw, WoolCut18-R 18V Reciprocating Insulation Saw, and any Insulation Knife or Insulation Hand Saw. It can also be used with electric insulations saws from BOS, FST, or DWT, using the adapters and templates provided.

Specifications

Max. Cutting Height	53" (1350mm)
Cutting Depth	2" to 11.8" (50 to 300mm)
Cutting Angle	Left: 0° - 90° Right: 0° - 90°
Ruler Markings	Left: 1.6" to 28" (40 to 710mm) Right: 2.8" to 28" (70 to 710mm)
Weight	45 pounds (20.5 kg)
Folded Dimensions	76" x 15.7" x 8.3" (1930 x 400 x 210mm)

Includes

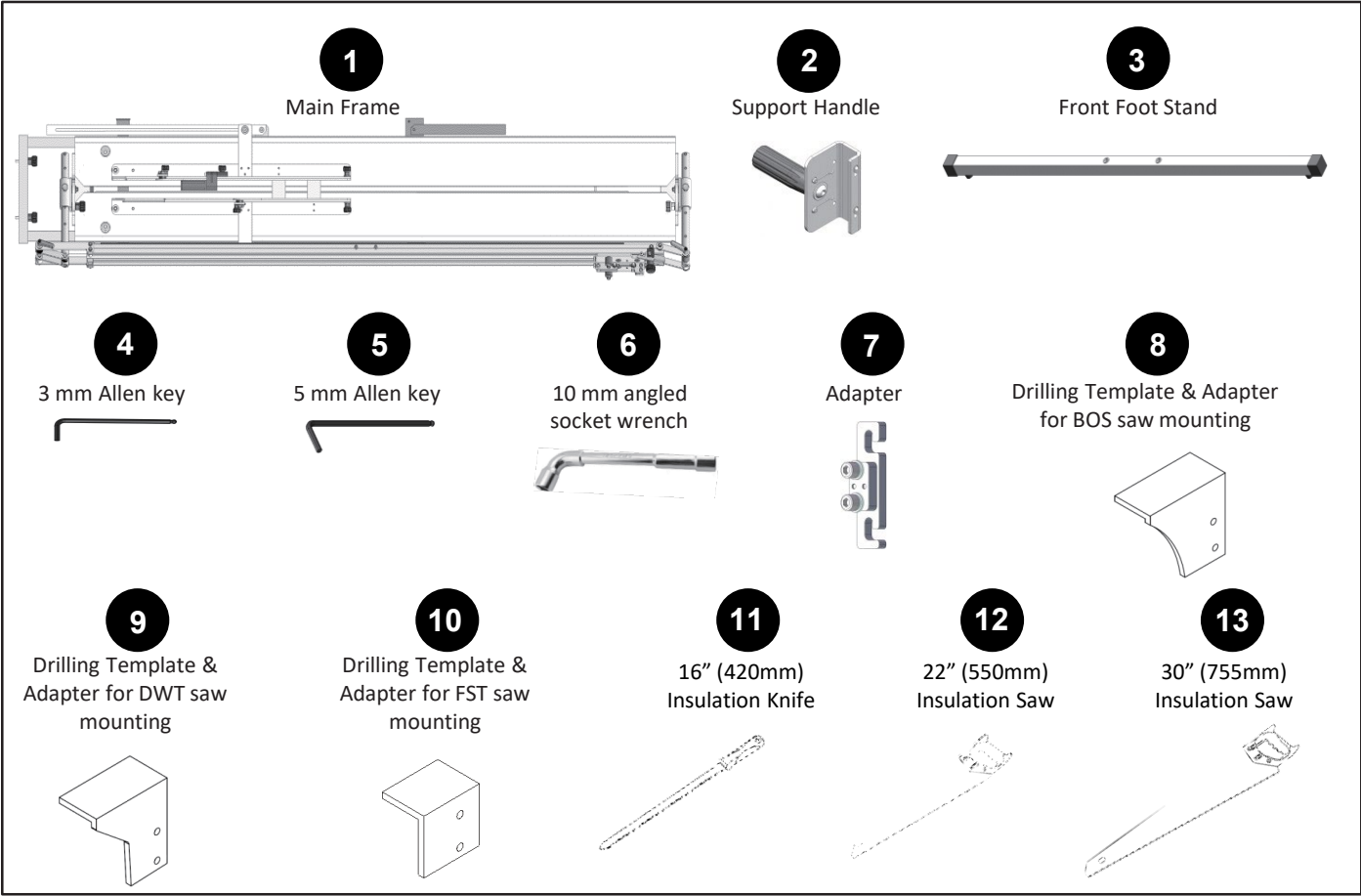

General Safety

Please read all instructions and safety advisories. Failure to follow the instructions and advice can lead to electric shock, and/or serious injuries. Please save this document for future reference.

1. Workplace Safety

- a) Ensure the workspace is clean and well-lit. Poorly lit and messy, or cluttered, workspaces can lead to accidents.
- b) Keep children and other persons away while operating the tool. Distractions can result in loss of control and accidents.
- c) Store the tool in a secure place when not in use. Do not allow persons not familiar with the tool, or persons who have not read this manual, to operate the tool.

2. Personal Safety



- a) Stay alert when operating the Insulation Cutting Station.
- b) Wear appropriate clothing. Do not wear baggy or loose clothing or jewelry. Avoid placing your hair, clothes or gloves close to the Cutting Station during operation. Clothing, hair and jewelry can be caught up in moving parts.
- c) Wear appropriate personal protection equipment based on the material being cut.

3. Maintenance and Service

- a) Before each use, check that all nuts and bolts are tight.
- b) Clean the station with dry products only; do not use solvents.
- c) Use ONLY original replacement parts when servicing the tool. Any maintenance should be performed by qualified personnel.

Cutting Station Assembly, Setup & Operation

1. Remove the station from its box or case.

2. Assemble the front foot stand (3) to the station (1).

3. While holding the station in a vertical position, pull out the locking pin (1), press the retractable pin (2), and lower the rear support leg (3).

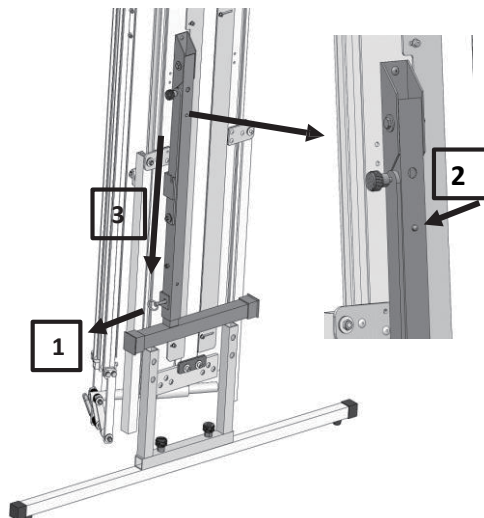
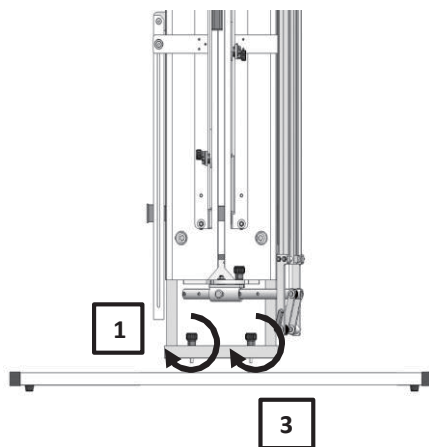
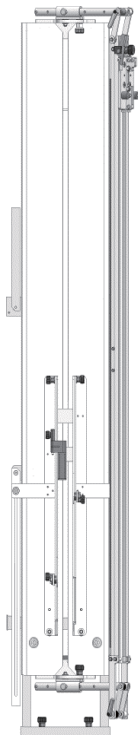

4. Slide the lower leg down and re-engage the retractable pin. Position the retaining lug (1) into the slot (2) and tighten the knob. Now reinsert the locking pin (3).

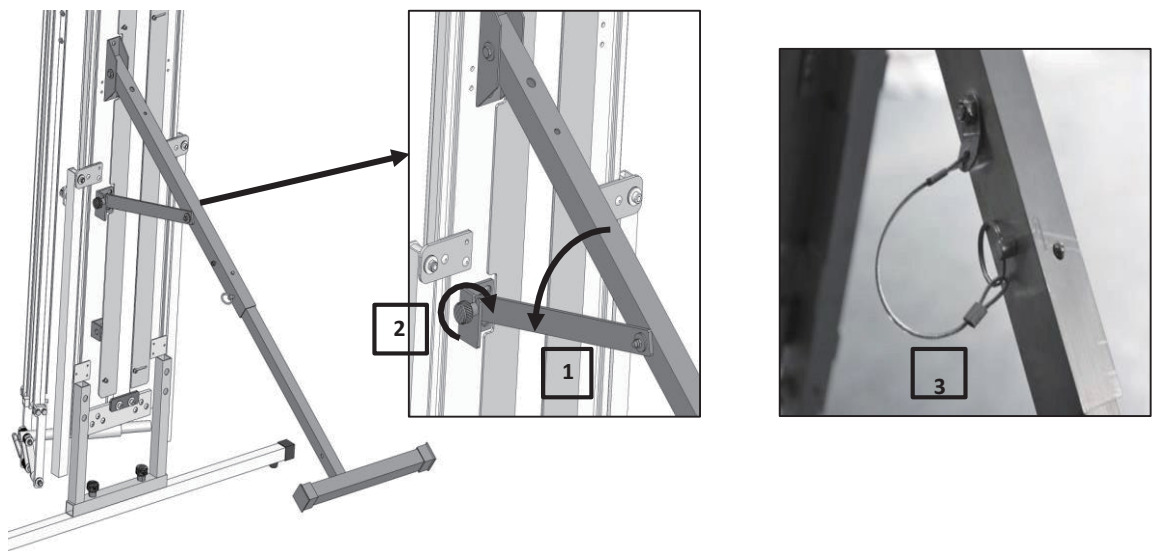

5. Loosen the plastic knob (1) and rotate the tubes (2) so they are perpendicular to the main panel. Next, loosen the aluminum knobs (3), unfold the material support rulers (4), then unfold the upper material supports (5).

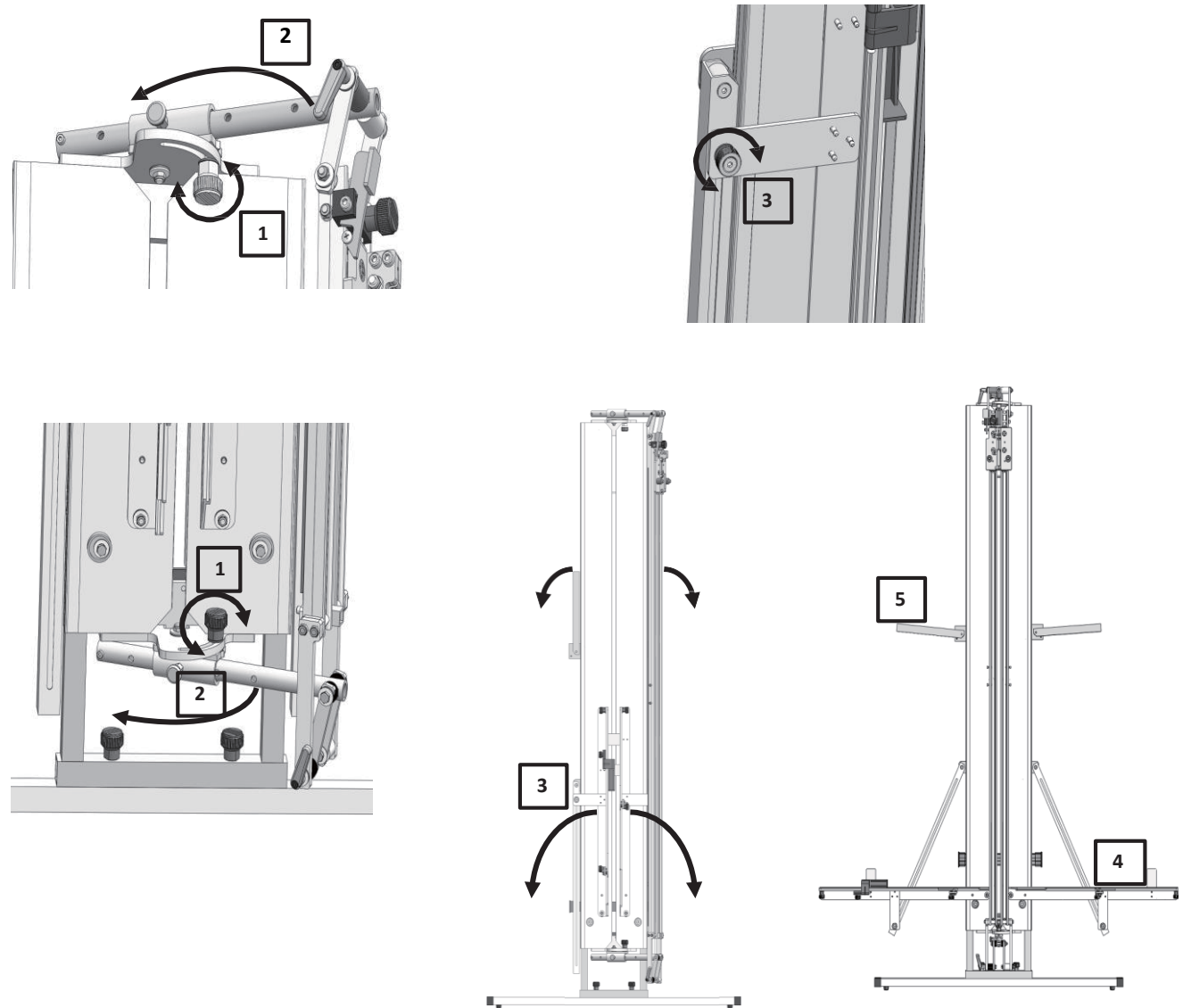

6. Loosen the top indexing handle (1). The spring pin (2) is in the third hole when initially unpacked; pull it out, slide it along the bar (3), and then insert it into the appropriate hole based on your material thickness. Repeat these steps for the bottom cutting guide. Finally, unfold and place the U-shaped support (4) against the wall to avoid cutting it with the saw.

Top Cutting Guide

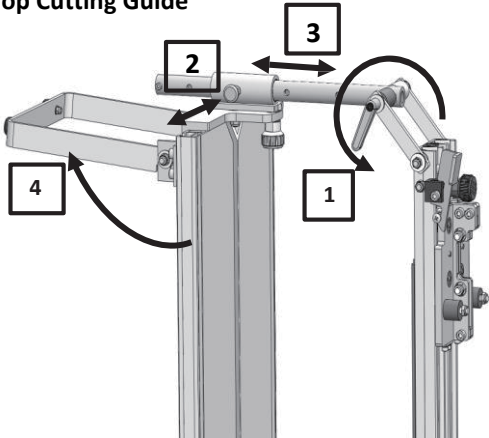

It is important to adjust the front cutting guide properly, based on the thickness of the material being cut. When properly adjusted, it is easy to hold and secure the material to the station, producing superior results.

Material Thickness Adjustment Guide

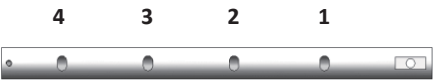

- Position 1:** From 2" to 4.7" (50 to 120 mm)
- Position 2:** From 4.3" to 7" (110 to 180 mm)
- Position 3:** From 6.7" to 9.4"(170 to 240 mm)
- Position 4:** From 9" to 11.8" (230 to 300 mm)

Bottom Cutting Guide

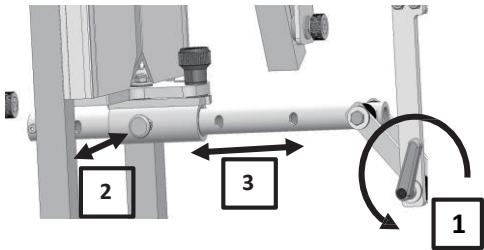

7. The side handle can be installed to the left or right side of the cutting guide, based on your personal preference. Use the Allen Key included with the station to tighten the bolts.

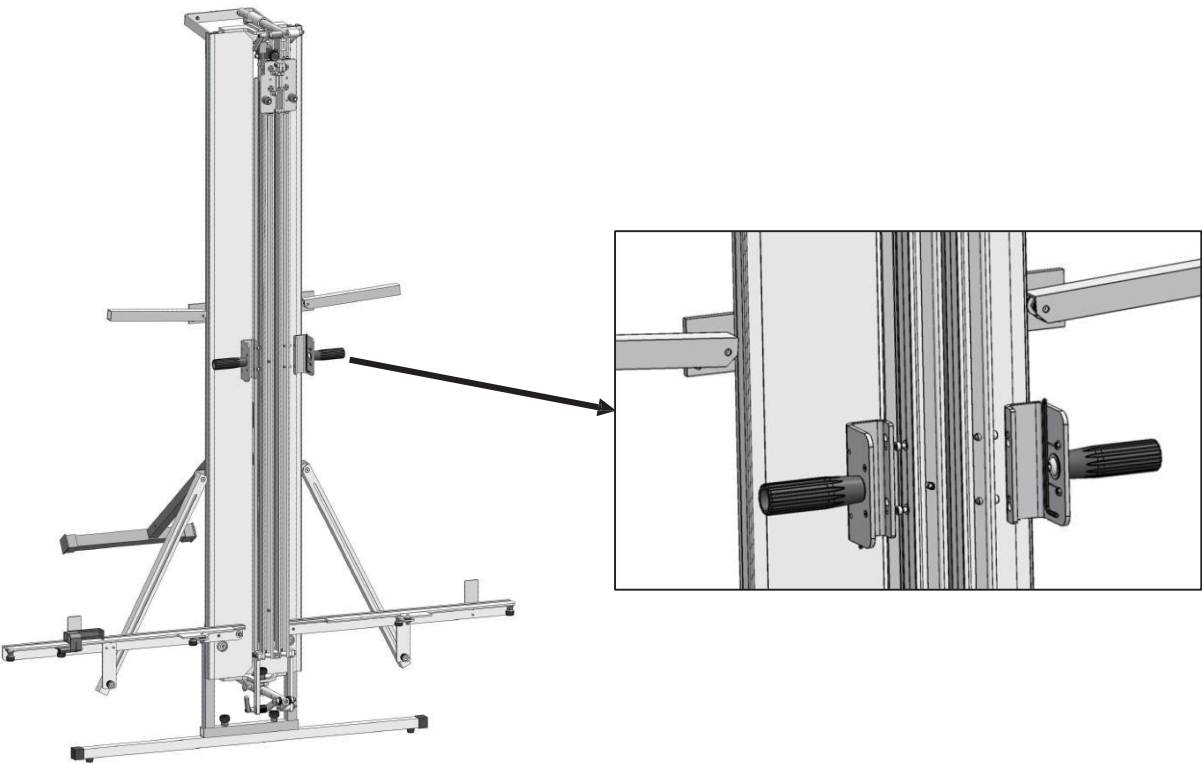

8. To attach the WoolCut™18 Insulation Saw to the Cutting Station, attach the adapter (1) to the blade holder of the WoolCut™18, using the 5 mm Allen key. Now attach the saw to the Cutting Station by connecting the adapter to the Cutting Carriage. Tighten the two nuts (2) using the 10 mm angled socket wrench.

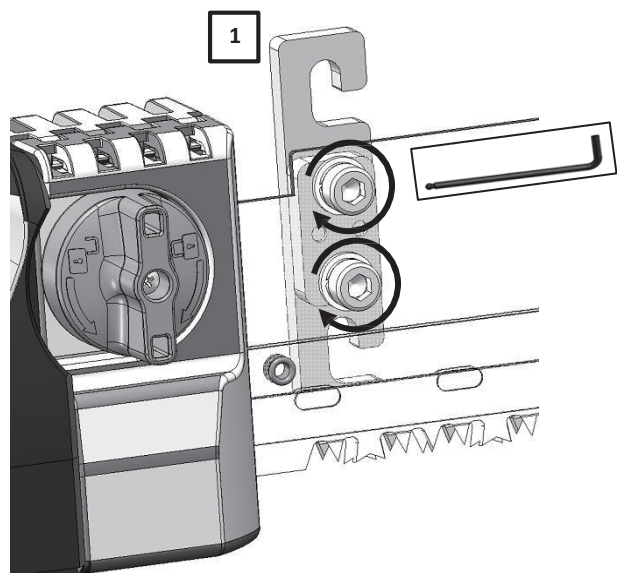

NOTE: To attach insulation saws from BOS, FST, or DWT, please see Step 13.

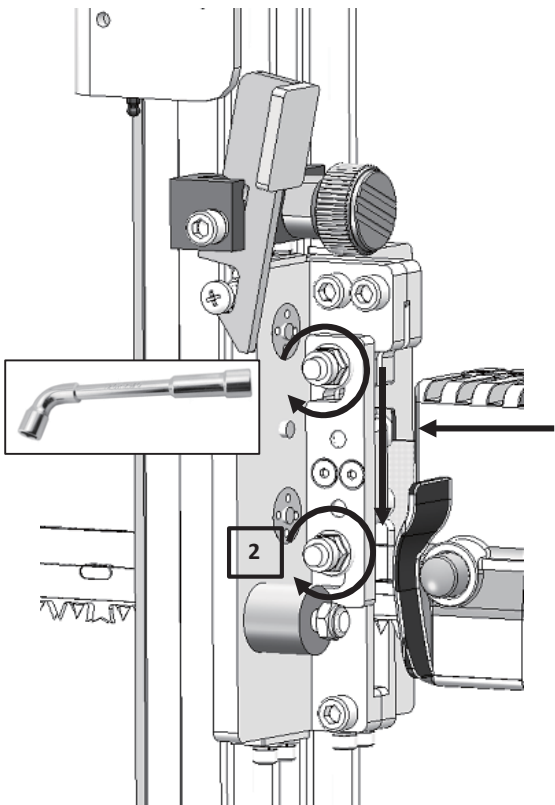

9. To attach the WoolCut18-R Reciprocating Insulation Saw to the Cutting Station, attach the dedicated adapter (1), sold separately. Then hook the Saw with Adapter onto the Cutting Carriage and tighten the two nuts (2) using the 10 mm angled socket wrench.

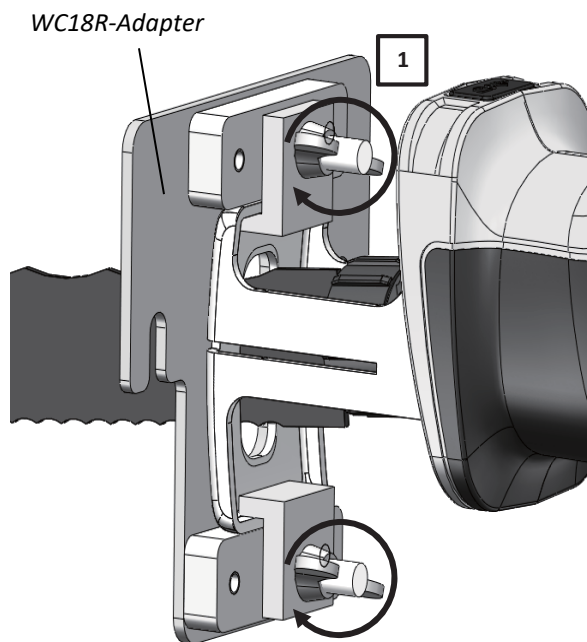

WC18R-Adapter Sold Separately

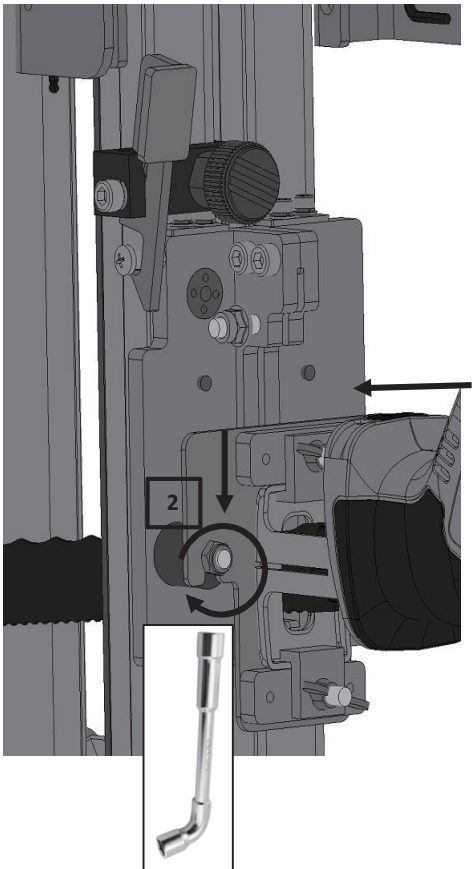

10. The blade opening of the Cutting Station should be adjusted based on the saw being used to cut the material. Using the 3 mm Allen key, loosen the screws at the top, middle and bottom of the backside of the main frame. Adjust the gap to the appropriate position based on the thickness of the blades. Then tighten the screws.

For serrated saw blades, or dual saw blades, adjust the gap to the largest setting.

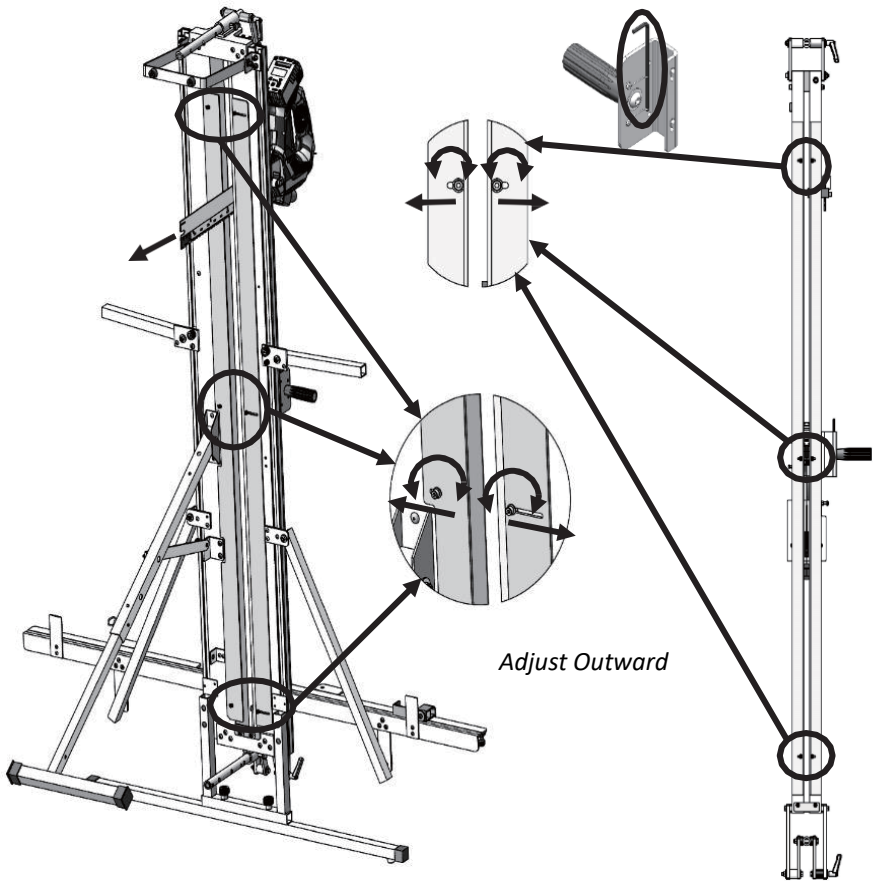
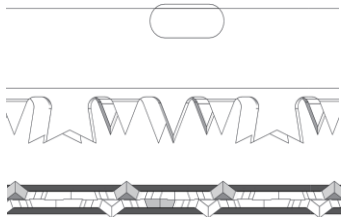

For wavy saw blades and single saw blades/knives, adjust the gap to the appropriate position.

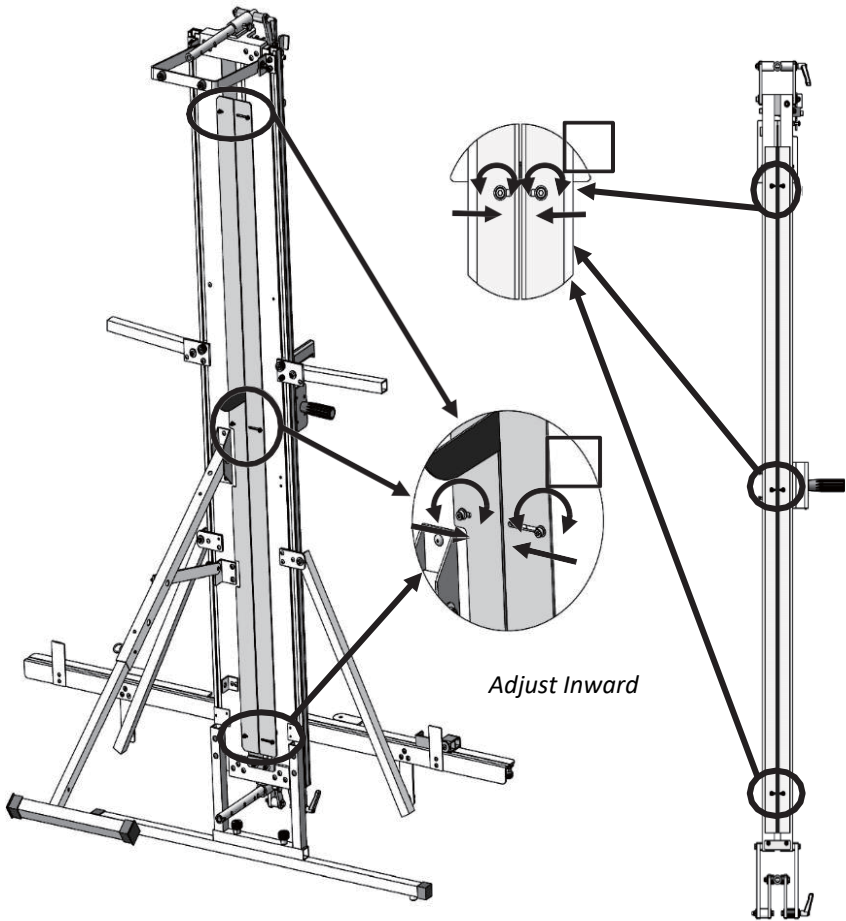
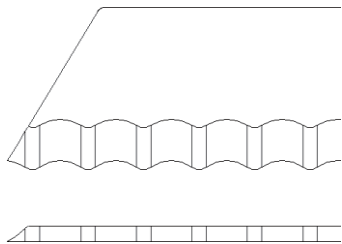

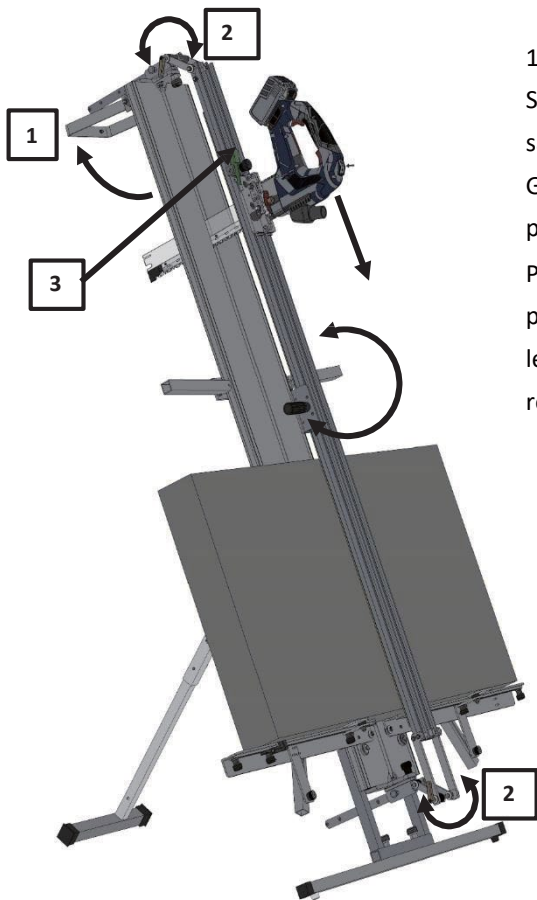

11. Before operating the Cutting Station, first ensure that the U-Shaped Support (1) is unfolded. This will prevent interference with the saw or knife when cutting. Next, loosen the levers (2), pull the Cutting Guide upwards, then tighten the levers (2) to hold the guide in the proper position.

Position the material to be cut, loosen the top and bottom levers (2), press on the support handle to compress the material and tighten the levers. NOTE: Do not press too hard. Finally, depress the hook (3) to release the carriage and start the cut.

12. To operate the WoolCut-300 in a tighter space, you can collapse the Rear Support Leg (1), unfold the U-Shaped support (2) and lean the Cutting Station against the wall, positioning it at an appropriate, stable angle.

The WoolCut-300 features a magnet (3) on the right side of the main frame. The Insulation Knife can be conveniently attached to the magnet when not in use.

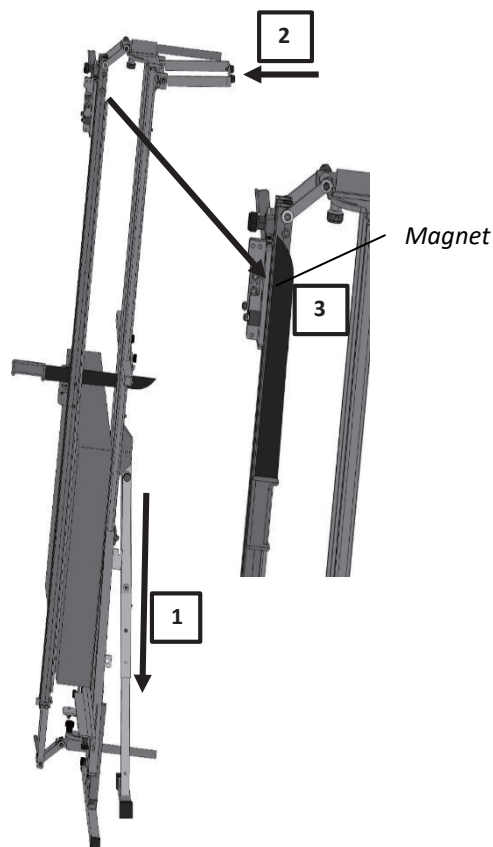

POSSIBLE CUTTING SHAPES

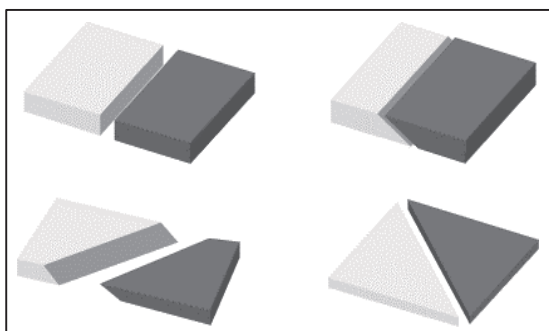

13. To use the Station with a BOS, FST or DWT insulation saw, follow the steps below. Drill 2 holes $\varnothing 1/4"$ (6.5 mm) using the corresponding drilling templates, then fit the adapter to the saw in order to attach it to the Station (see step 8).

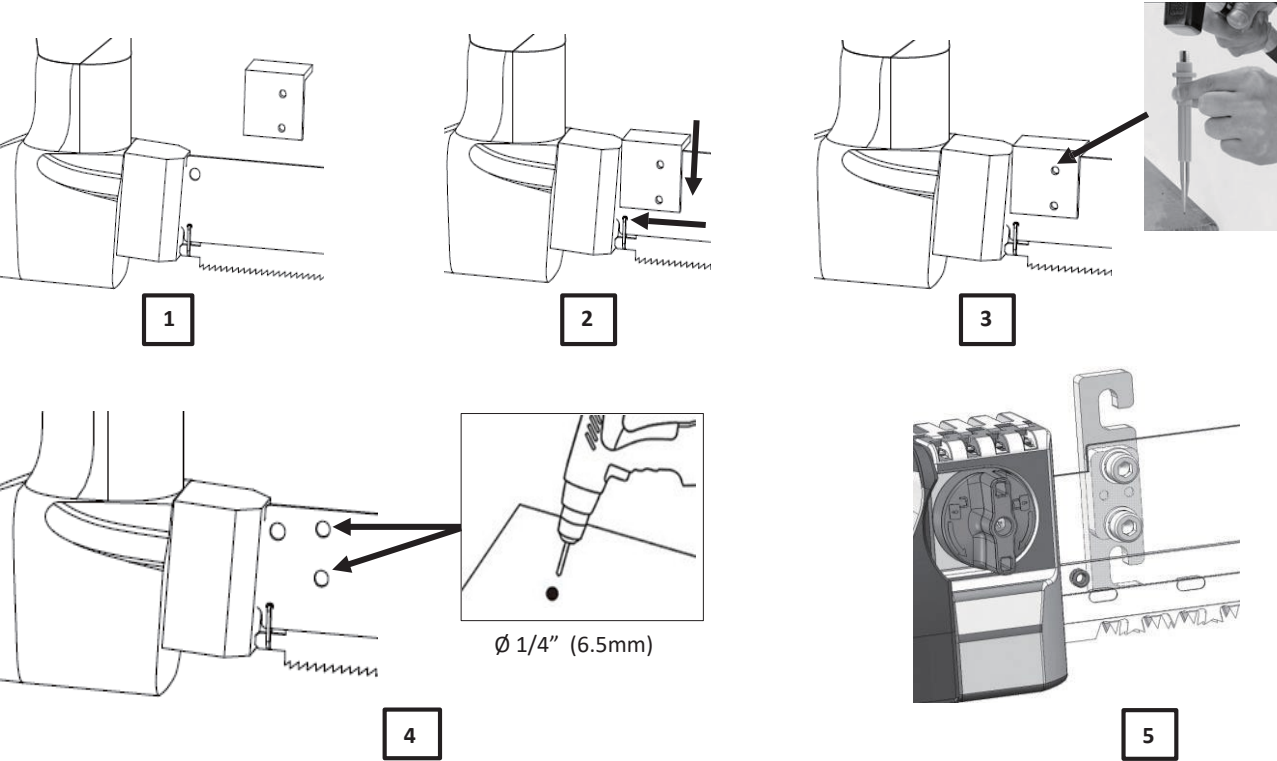

BOS saw

DWT saw

FST saw

