

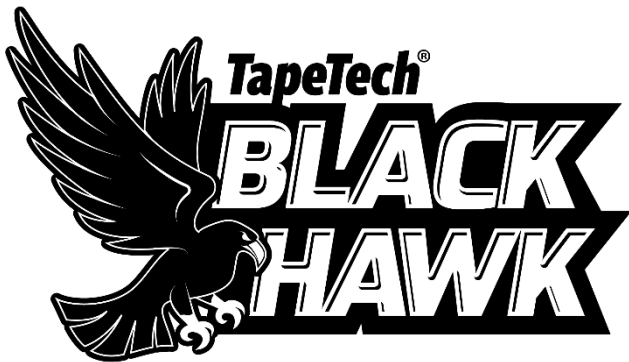

WOOLCUT™18-R

18V Li-Ion Reciprocating Saw for Mineral Wool Insulation

User Manual



- Please read these instructions carefully before operation
- Take special note of the guidelines and safety prompts in these instructions to avoid injury to yourself, other people and objects, or damage to the tool.

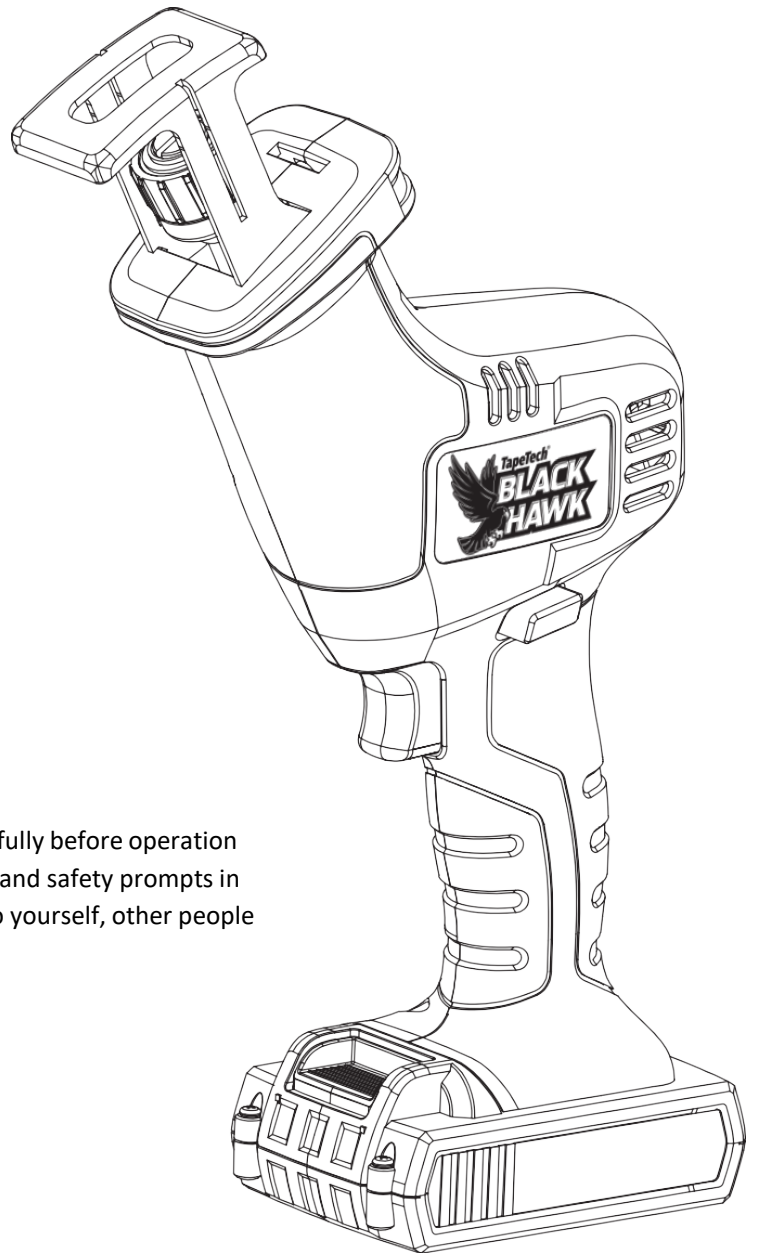

General Safety

Please read all instructions and safety advisories. Failure to follow the instructions and advice can lead to electric shock, and/or serious injuries. Please save this document for future reference.

1. Workplace Safety

- a) Ensure the workspace is clean and well-lit. Poorly lit and messy, or cluttered, workspaces can lead to accidents.
- b) Do not operate the Insulation Saw in areas with flammable liquids, gases or dust. Depending on the material being cut, the vibrating wire can create sparks which can ignite the liquid, vapors or dust.
- c) Keep children and other persons away while operating the tool. Distractions can result in loss of control and accidents.
- d) Store the tool in a secure place when not in use. Do not allow persons not familiar with the tool, or persons who have not read this manual, to operate the tool.

2. Electric Safety

- a) Avoid contact with grounded surfaces like pipes, heaters, cookers and refrigerators. If your body is grounded, an increased risk of electric shock exists.
- b) Do not operate the Reciprocating Saw in rain or high humidity areas. Water entering the Power Head would increase the risk of electric shock.
- c) Do not operate the tool if the power switch is not operating properly. Replace the switch immediately.
- d) Remove the battery before adjusting the tool, changing the cutting wire or storing the tool. This precaution prevents the inadvertent activation of the Reciprocating Saw.

3. Personal Safety

- a) Stay alert when operating the Reciprocating Saw.
- b) Avoid inadvertent activation of the Reciprocating Saw. Be sure that the switch is turned off before connecting the battery to the tool.
- c) Remove and safely store wrenches, screwdrivers and other adjusting tools before turning on the Insulation Cutter.
- d) Wear appropriate clothing. Do not wear baggy or loose clothing or jewelry. Avoid placing your hair, clothes or gloves close to the vibrating wire during operation. Clothing, hair and jewelry can be caught up in the moving parts.
- e) Be sure that any dust collection devices are properly connected and used correctly.
- f) Wear appropriate personal protection equipment based on the material being cut.

4. Use and Handling of Battery-Powered Tools

- a) Recharge the batteries provided with the Reciprocating Saw using ONLY battery chargers approved by the manufacturer. Using unapproved chargers presents a risk of fire.
- b) Use ONLY the batteries provided with the Reciprocating Saw, other approved TapeTech batteries, or other approved batteries in conjunction with an approved battery adapter. Failure to comply may lead to fire and/or injury.
- c) When the battery is not in use, keep it away from paper clips, coins, nails, screws and other small, metallic objects that could cause the battery contacts to connect. If the battery contacts short circuit, it may lead to burns or fire.
- d) If used incorrectly, or if damaged, fluid may emerge from the battery. Avoid contact with that fluid. In the case of accidental contact with the body, promptly rinse the area thoroughly with water. If the battery fluid comes in contact with the eyes, immediately seek medical attention. Battery fluid can lead to irritation or burns of the skin. Check that any fluid that leaked did not coat adjacent parts of the tool. If this occurred, clean or replace the parts, as needed.
- e) Do not open the batteries as this can lead to the risk of a short circuit.
- f) If the battery becomes damaged, vapors may emerge from the battery. These vapors can lead to irritation of the respiratory system. Get fresh air immediately and seek further medical attention if symptoms persist.

5. Reciprocating Saw Safety

- a) Do not overload the tool during use. Move the blade through the material at an appropriate speed based on density and thickness. Overloading the tool can cause the blades to jam. If this occurs, immediately turn off the power switch.
- b) Do not lean too far. Keep a firm footing and good balance during operation of the tool.
- c) Check that the blade holder and blades are correctly installed before operation. Be sure the blades are sharp and clean. Properly maintained blades are less likely to jam or overload the tool.
- d) Keep handles and gripping surfaces dry, clean and free from oil or grease. Slippery surfaces make it difficult to operate safely.

6. Maintenance and Service

- a) All bearings in this tool are lubricated with a sufficient amount of high-grade lubricant for the life of the tool under normal conditions. No further lubrication is required.
- b) Use ONLY original replacement parts when servicing the tool. Any maintenance should be performed by qualified personnel.

Intended Use

WOOLCUT™18-R BLACK HAWK Reciprocating Saw is specially designed for cutting insulation material, including Rockwool, mineral wool, and wood fiber rolls and panels. It can also be used to cut Sheep Wool, Cellulose Wadding and Glass Wool. Do Not use this tool for cutting wood, metal, or plastic.

Specifications

TOOL SPECIFICATIONS				
Stroke Length	.787" (2 cm)		Motor	18V DC Brushless
No-load Stroke Rate	0 – 3,000 strokes/minute		Weight w/Battery	3.17 lbs (1.44 kg)
Included Blades	Special Double Edge Wavy/Toothed Blades: (1) 8" (200mm) and (1) 13.8" (350mm)			

BATTERY			CHARGER	
Rated Voltage	18V		Input Voltage	100-240V AC/50-60 Hz
Capacity	2.0 Ah Li-Ion		Output Voltage	21V
Weight	0.75 lbs (0.34kg)		Output Current	2.3 Amps
Features: Power Display			Weight	0.57 lbs (0.26kg)
Includes: Overload Protection			Charging Time	60 minutes

Charging the Battery

Note: The battery is partially charged on delivery

To ensure full battery capacity, charge the battery in the charger before the first use. Pay attention to the charge indicator on the charger; the red light indicates the battery is charging. The green light indicates the battery is fully charged. The Li-Ion battery can be recharged at any time without affecting the overall life of the battery. Interrupting the charging process – or partially charging the battery – does not damage the battery.

The battery is equipped with a temperature monitoring system that only allows for charging between 32° F and 113° F (0° C and 45° C)

Removing the Battery

The battery is equipped with a locking mechanism. As long as the battery remains inside the body of the reciprocating saw, it is held in position by a spring. To remove the battery, press the gray button and slide the battery off the power head. Do not use excessive force.

Notices Regarding Optimal Handling of the Battery

Keep the battery away from water or damp conditions. Store the battery at temperatures between 32°F and 113°F (0° – 45°C). Do not leave batteries in vehicles during periods of extreme heat or cold.

If the battery begins to operate for shorter and shorter periods of time following a recharge, the battery life is exhausted and the battery should be replaced.

Key Components

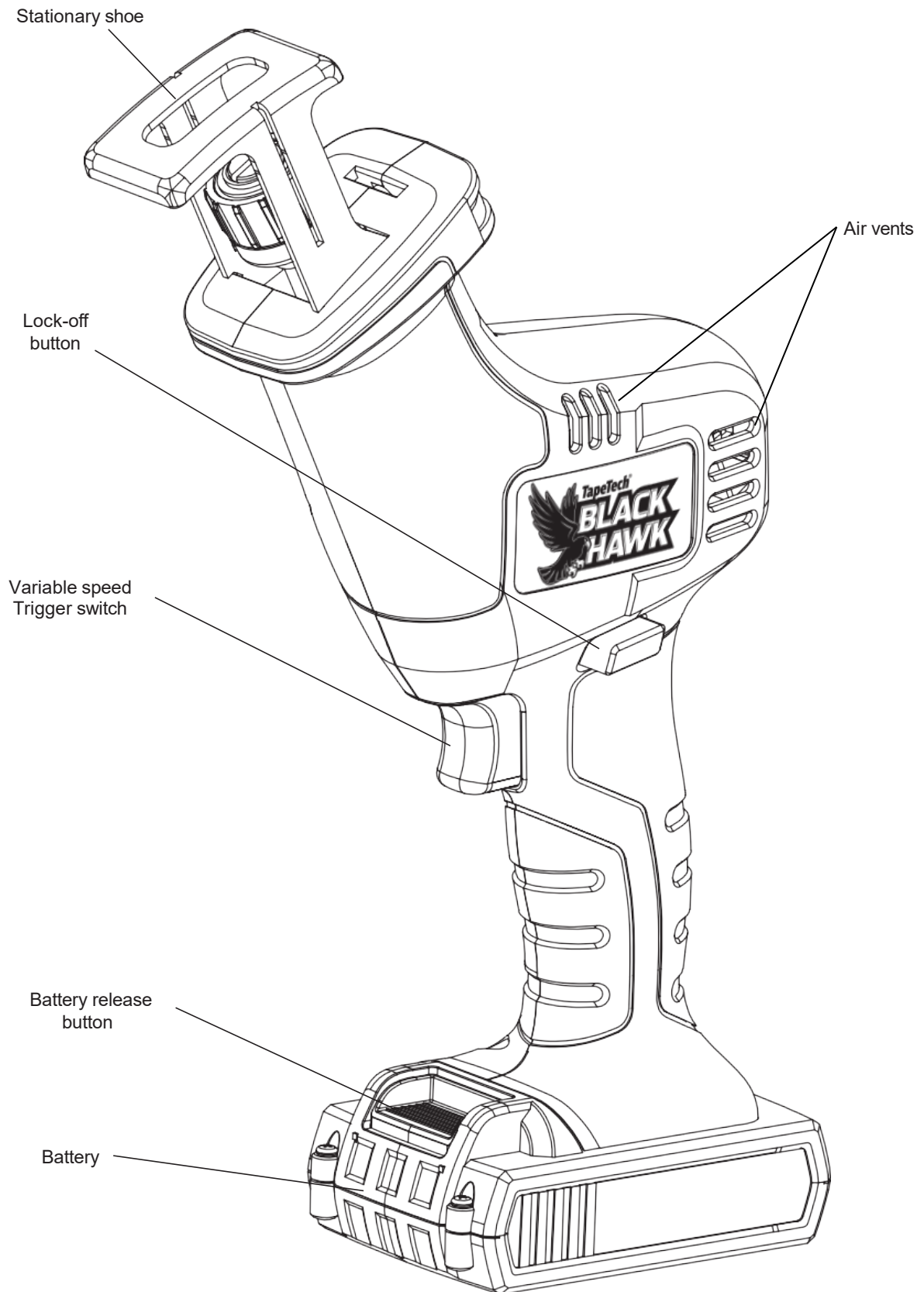

Tool Operation

LOCK-OFF BUTTON

The lock-off button (1) is a safety device designed to reduce the possibility of accidentally starting the saw. This button must be pressed before the trigger switch (2) can be squeezed.

NOTE: The lock-off button can be pressed from either the left or right side of the handle.

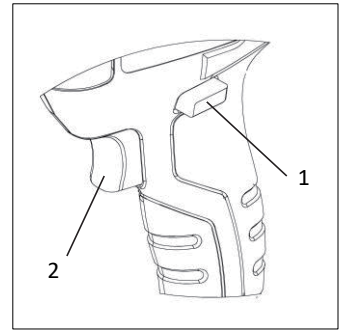

VARIABLE SPEED TRIGGER SWITCH

The variable speed trigger switch functions to turn the tool on and off, as well as control the speed of the saw.

To turn the saw ON:

1. Depress the lock-off button with your thumb
2. While holding the lock-off button in the depressed position, gently squeeze the trigger switch. The saw will start at its slowest speed.
3. Once the saw starts, you can release the lock-off button. The saw will remain running until the trigger switch is released.
4. To increase the speed of the saw, squeeze the trigger switch harder.
5. To turn the saw OFF, release the trigger switch.

BLADE INSTALLATION AND REMOVAL

WARNING: Always remove the battery before installing or removing a blade, or adjusting the saw in any way.

To INSTALL a blade in the saw:

1. Rotate the blade-locking collar clockwise (1) as far as it will go.
2. Insert the appropriate blade (2) into the Blade Slot (3) as far as it will go.
3. Release the blade-locking collar.

NOTE: Pull outward on the blade to ensure it is properly locked in the blade holder.

To REMOVE a blade from the saw:

1. Rotate the blade-locking collar clockwise as far as it will go and remove the blade from the blade holder.

NOTE: It is recommended to use protective gloves during blade installation and removal.

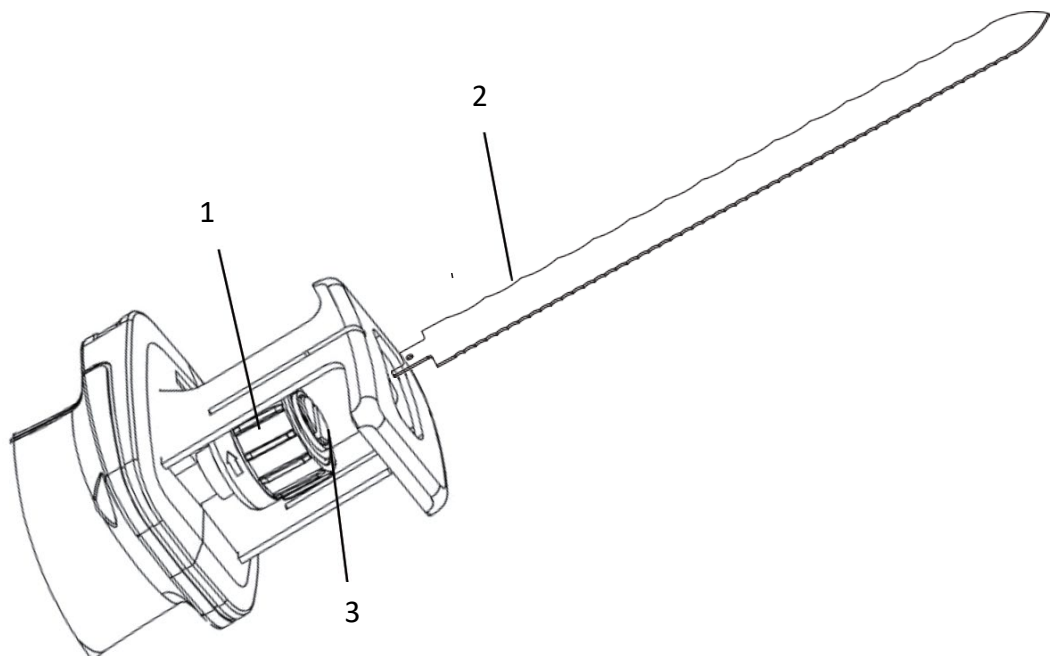

Inspection, Repairs, and Environmental Protection

DAILY INSPECTION:

- Ensure the body or the tool and the handle are not damaged.
- If the battery charger or battery are damaged, please stop using them immediately and replace the defective/damaged product.
- Ensure that the Trigger Switch operates smoothly.
- Ensure that the blade operates freely.

REPAIRS:

- Repairs should be made ONLY by properly trained persons.

ENVIRONMENTAL PROTECTION

Please observe national laws and regulations concerning the environmental treatment and recycling of discarded tools and equipment, packaging and accessories. Please render discarded power tools unusable by removing the battery pack and disposing of or recycling properly.

Do not dispose of batteries in household waste. Do not throw batteries into water or fire. Batteries should be collected and recycled, or disposed of, in an environmentally-friendly collection and sorting center provided by your local municipality.

Parts and Accessories

Part #	Description
WC18R-Blade8W	8" (200mm) Wavy Reciprocating Saw Blade for WoolCut18-R
WC18R-Blade13W	13.8" (350mm) Wavy Reciprocating Saw Blade for WoolCut18-R
EBAT1820	18V/2.0Ah Battery
EBAT1850	18V/5.0Ah Battery
EBAT1880	18V/8.0Ah Battery